

WOSWC0263 WOSWC0463

*See current catalogue for further detail

Cleaning Guide:

Spraying cleaning products on to electrical products is not recommended. It is important to ensure that switches are turned off before cleaning.

Do not use any cleaning sprays - only wipe down with damp cloth or rub with dry cloth. (Do not use an abrasive cloth as it may scratch the plastic).

Do not use harsh chemical cleaners as these can break down the plastic and cause it to crack.

Page 1 of 2



Wolverine Changeover Switch series 63A



Overview:

Changeover switches for use with alternative or stand-by generators typically mounted in main switch boards with the switch actuator positioned in the centre off position. The incoming changeover must be protected with an appropriate MCB 63A - 6kA - C curve to protect against short circuit and disconnection. Refer to AS/NZS 3000 (wiring rules), AS/NZS 3010 (Electrical installations - Generating sets) and local Service and Installation Rules for specific requirements. Please note that in Australia and NZ, the Main Supply Neutral upstream of the MEN connection is NOT allowed to be switched. The four pole cannot be used to switch a Neutral prior to an MEN in the main switchboard. It can however be used to connect to a generating set to a distribution switchboard without an MEN.

Specifications

| | | |
|---------------------|---|----------------------------------|
| Electrical Features | Rated Operational Current Ie | 63A |
| | Rated Operational Voltage Ue | 240V/415V (2P) 415V (4P) |
| | Number of Poles | 2P, 4P |
| | Type Of Current | AC |
| | Rated Insulation Voltage Ui | 690V |
| | Utilization Category | AC-22A |
| | Rated Short-Time Withstand Current Icw | 758A/1s |
| | Rated Frequency | 50Hz |
| | Rated Impulse Withstand Voltage Uimp | 6kV |
| | Rated Duty | Uninterrupted |
| Mechanical Features | Standard | AS 60947-3:2018 |
| | Approval certificate number | GMA-520981 |
| | Pollution Degree | 3 |
| | Ambient Temperature | -50c Degrees To +40oc |
| | Protection Degree | IP20 |
| | Humidity | Should Not Exceed 50% At 40oc |
| | Method Of Operation | Independent Manual Operation |
| Installation | Terminal Size Top/Bottom For Busbar | 25mm ² |
| | Terminal Size Top/Bottom For Cable | 25mm ² |
| | Maximum Tightening Torque | 1.5 N*m |
| | Recommended tightening torque for terminals | 1.5 N*m |
| | Number Of Positions of The Main Contacts | 2 |
| | Module width | 36 & 72 |
| | Connection | From top or bottom are available |
| | Switching Type | Suitable For Isolation |

Certification Number:
GMA-520981

GSM Electrical (Australia) Pty Ltd
Level 2, 142-144 Fullarton Road, Rose Park SA 5067
P: 1300 301 838 F: 1300 301 778 E: service@gsme.com.au
www.gsme.com.au



Data Specification Sheet
January 2025

WOSWCO263
WOSWCO463

*See current catalogue for further detail

Wolverine Changeover Switch series 63A

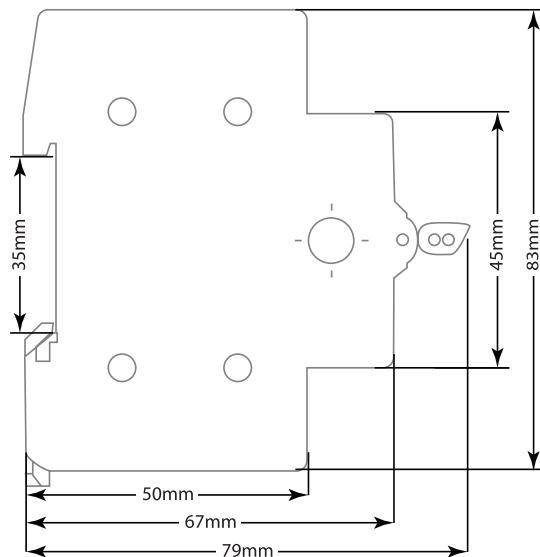
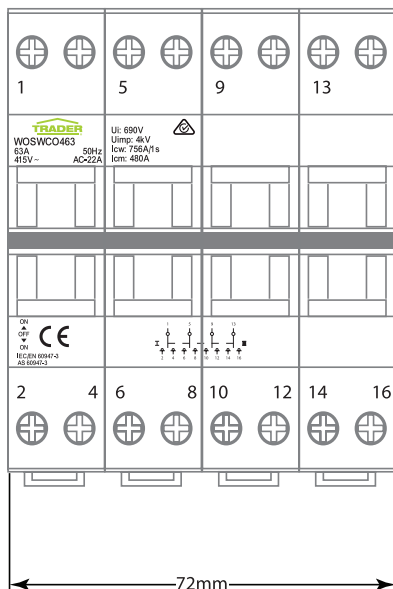



Cleaning Guide:

Spraying cleaning products on to electrical products is not recommended. It is important to ensure that switches are turned off before cleaning.

Do not use any cleaning sprays - only wipe down with damp cloth or rub with dry cloth. (Do not use an abrasive cloth as it may scratch the plastic).

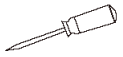
Do not use harsh chemical cleaners as these can break down the plastic and cause it to crack.

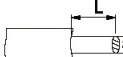
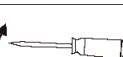
| | |
|---|---|
|  |  |
|  | L:12mm S:(1-10)mm² |
|  | Recommended 1.5Nm |

Page 2 of 2

Mounting

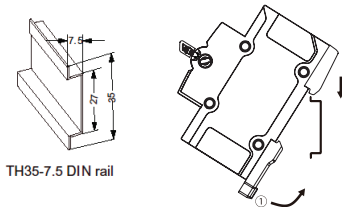

Dismounting

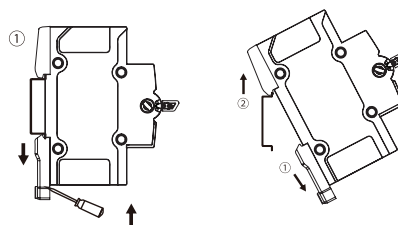

| Catalogue Number | Description |
|------------------|--|
| WOSWCO263 | Switch Changeover Din Mount 2 Pole 63A 240 415V ac AC22A |
| WOSWCO463 | Switch Changeover Din Mount 4 Pole 63A 415V ac AC22A |

Certification Number:
GMA-520981

GSM Electrical (Australia) Pty Ltd
Level 2, 142-144 Fullarton Road, Rose Park SA 5067
P: 1300 301 838 F: 1300 301 778 E: service@gsme.com.au
www.gsme.com.au



Data Specification Sheet
January 2025