

WOMSW180
WOMSW1100
WOMSW2100
WOMSW380
WOMSW3100

WOLVERINE Main Switch Series

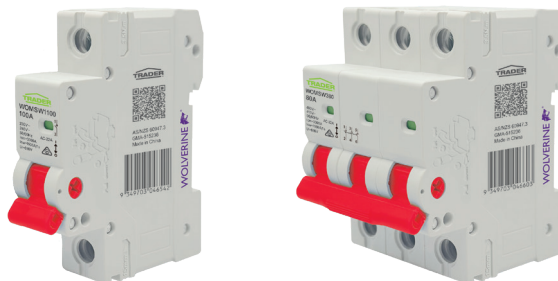

Overview:

Wolverine Din Rail mounted Main Switch Isolators (WOMSW series) offer fast and flexible installation and is suitable for residential and light commercial applications. Offering reliable performance for board configurations suited up to 100A and utilizing red switch toggles for easy identification along with the green/red indication of internal contact positions.

Perfect for applications where isolation is required either in the main or in local sub boards the WOMSW are only switches and do not operate to provide additional circuit protection, other models in Wolverine range offer this application.

Specifications

Electrical Features	Rated Operational Current Ie	80A, 100A
	Rated Uninterrupted Current Iu	80A, 100A
	Conventional Free Air Thermal Current Ith	80A, 100A
	Rated Operational Voltage Ue	230 Or 240V~(1P), 400 Or 415V~(3P)
	Number of Poles	1P, 2P or 3P
	Type Of Current	AC
	Rated Insulation Voltage Ui	690V
	Utilization Category	AC-22A
	Rated Short-Time Withstand Current Icw	1500A/1s
	Rated Short-Time Making Capacity	3000A
	Rated Frequency	50/60Hz
	Rated Impulse Withstand Voltage Uimp	6kV
	Rated Duty	Uninterrupted
Mechanical Features	Standard	AS 60947-3:2018
	Approval certificate number	GMA-515236
	Pollution Degree	3
	Ambient Temperature	-50c Degrees To +40oc
	Protection Degree	IP20
	Humidity	Should Not Exceed 50% At 40oc
Installation	Method Of Operation	Independent Manual Operation
	Terminal Size Top/Bottom For Busbar	50mm ² Max
	Terminal Size Top/Bottom For Cable	25mm ²
	Maximum Tightening Torque	3.5 N*m
	Recommended tightening torque for terminals	1.5 N*m
	Number Of Positions of The Main Contacts	2
	Module width	18 & 54
	Connection	From top or bottom are available
	Switching Type	Suitable For Isolation

Standard Number:

AS 60947.3

Certification Number:

GMA-515236

GSM Electrical (Australia) Pty Ltd

Level 2, 142-144 Fullarton Road, Rose Park SA 5067

P: 1300 301 838 F: 1300 301 778 E: service@gsme.com.au

www.gsme.com.au



Data Specification Sheet
January 2024



WOMSW180
WOMSW1100
WOMSW2100
WOMSW380
WOMSW3100



WOLVERINE Main Switch Series

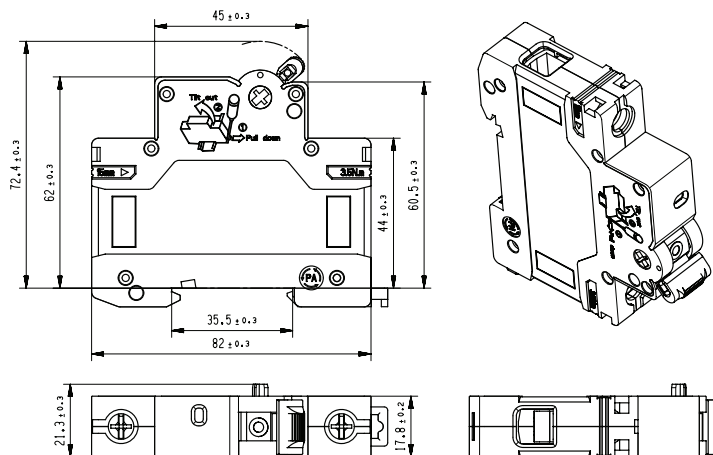

Installation Instruction

This product **MUST** be installed by a licensed electrician.

Line and Load can be top or bottom.

To avoid damage to Main Switch disconnect before insulation testing Connect the Neutral cable before the Line active cable.

- Used in domestic installations, as well commercial electrical distribution systems.

Wiring

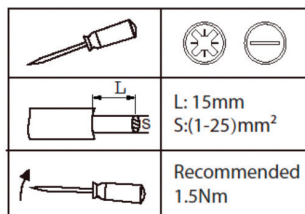

Status Indication

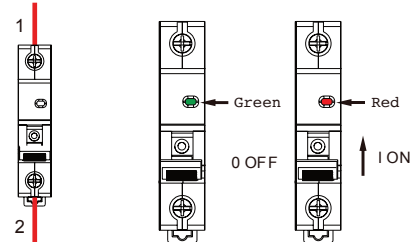

Mounting

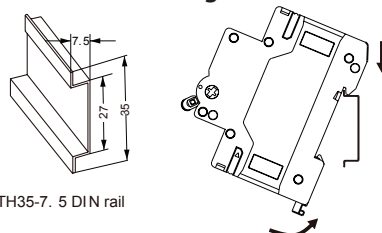

Dismounting

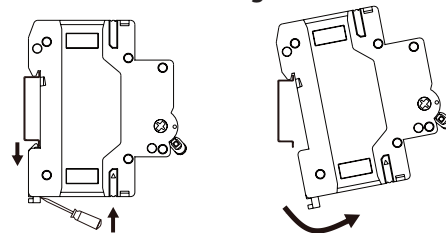

Page 2 of 2

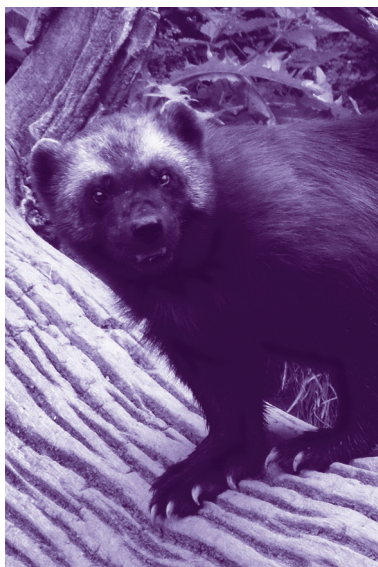

Catalogue Number	Description
WOMSW180	Main Switch 1 Pole 80A 230V 240V 1 Module
WOMSW1100	Main Switch 1 Pole 100A 230V 240V 1 Module
WOMSW2100	Main Switch 2 Pole 100A 400V 415V ac 2 Module
WOMSW380	Main Switch 3 Pole 80A 400V 415V 3 Module
WOMSW3100	Main Switch 3 Pole 100A 400V 415V 3 Module

Standard Number:

AS 60947.3

Certification Number:

GMA-515236

WOMSW2100: GMA-515236

GSM Electrical (Australia) Pty Ltd

Level 2, 142-144 Fullarton Road, Rose Park SA 5067

P: 1300 301 838 F: 1300 301 778 E: service@gsme.com.au

www.gsme.com.au



Data Specification Sheet
January 2024