

#### Features

- NDIS compliant touch pad size (>35mm wide).
- Glass touch surface.
- Colour tuneable touch pads (RGBW).
- Slim magnetic glass fascia.
- Fits standard Australian wall boxes and mounting accessories that use 84mm mounting centres.
- Bluetooth mesh connectivity with each device acting as a repeater.
- Silverfish antenna technology.
- 2 year warranty.
- Automatic schedules.
- Auto off timers.
- Real time energy usage in watts & dollars.
- Power outage recovery.
- Power lock.
- Individual socket control.
- Night light on/off and auto dim.
- High energy use alert.
- Switching from other Zimi devices with Behaviour Link.
- Voice control with your favourite voice assistant.\*

Learn more at [www.zimi.life](http://www.zimi.life)

#### Specifications

| Product Code | Colour | Description                                     | Max Load Rating   | Line Voltage Freq. |
|--------------|--------|---|-------------------|--------------------|
| SNASPP       | White  | Senoa Accessibility Power Point Switched 2 Gang | 10A @ 250V~ 2500W | 50Hz Nominal       |
| SNASPPBK     | Black  |   |                   |                    |

#### Dimensions (mm)

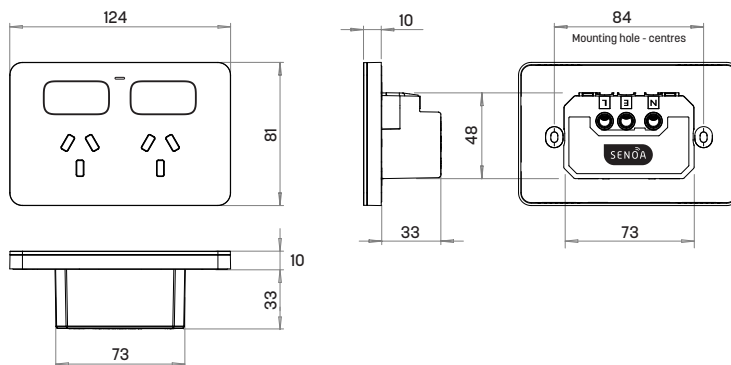

#### Wiring Guide

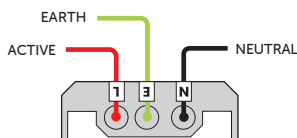

SNASPP



SNASPPBK

**Standards Approval:**  
AS/NZS 3112 & AS/NZS CISPR15

**Certification Number:**  
GMA-511359-EA



#### Download Zimi

Scan the code with your phone camera to download.



#### \* Zimi Cloud Connect

Enjoy the complete experience of all your Zimi devices with full functionality, reliable connectivity and energy history.

