



Power Point

DATA SHEET

Features

- Glass touch surface.
- Colour tuneable touch pads (RGBW).
- Slim magnetic glass fascia.
- Fits standard Australian wall boxes and mounting accessories that use 84mm mounting centres.
- Bluetooth mesh connectivity with each device acting as a repeater.
- Silverfish antenna technology.
- 2 year warranty.
- Real time energy usage in watts & dollars.
- Automatic schedules.
- Auto off timers.
- Power outage recovery.
- Power lock.
- Individual socket control.
- Night light on/off and auto dim.
- High energy use alert.
- Voice control with your favourite voice assistant. *

Learn more at www.zimi.life

Specifications

Product Code	Colour	Description	Max Load Rating	Line Voltage Freq.
SENPP	White	Senoa Power Point Switched 2 Gang	10A @ 250V~ 2500W	50Hz Nominal
SENPPBK	Black			

Dimensions (mm)

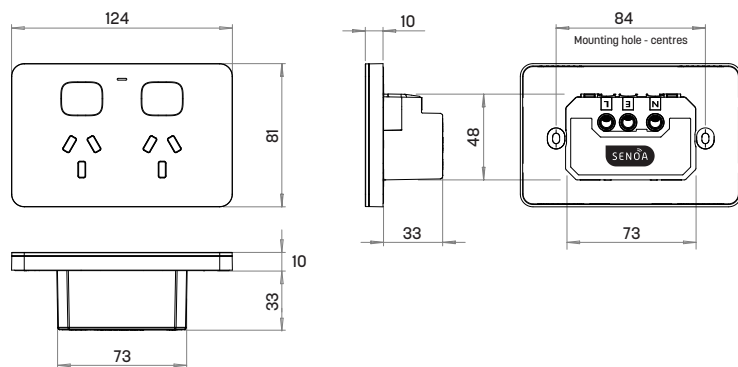

Wiring Guide

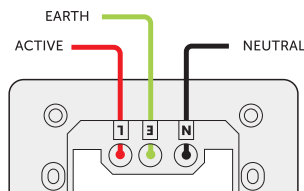

Standards Approval:
AS/NZS 3112 & AS/NZS CISPR15

Certification Number:
GMA-511359-EA



Download Zimi
Scan the code with your phone camera to download.



* Zimi Cloud Connect

Enjoy the complete experience of all your Zimi devices with full functionality, reliable connectivity and energy history.



zimi 14 Millennium Circuit, Helensvale, QLD 4212 Australia. www.zimi.life

Need help? email support@zimi.life visit <https://support.zimi.life>

SENŌA products must be installed by a qualified electrician. Zimi requires a compatible (Android, iOS) mobile device, minimum OS requirements are available at www.zimi.life. Availability and performance of certain features are service, device and network-dependent and may not be available in all areas; subscription(s) may be required, and additional terms, conditions and/or charges may apply. All features, functionality and other product specifications are subject to change without notice or obligation. SENŌA products are optimised for the use with the Zimi App. The Bluetooth word mark and logos are registered trademarks owned by the Bluetooth SIG, Inc. IOS is a trademark or registered trademark of Cisco Inc. Zimi and Powermesh and their respective logos are registered trademarks of Zimi Ltd. Google and Google Play are trademarks of Google LLC. Amazon, Alexa, and all related logos are trademarks of Amazon.com, Inc. or its affiliates. Apple, the Apple logo, Apple Watch and iPhone are trademarks of Apple Inc., registered in the U.S. and other countries. App Store is a service mark of Apple Inc., registered in the U.S. and other countries. Copyright © 2022 Zimi Ltd. All rights reserved.