

PMPUSWV1G3S PMPUSWV1G3BKS



WHITE Part No: PMPUSWV1G3S



BLACK Part No: PMPUSWV1G3BKS



Example of
PMPUSWV1G3S
With Leopard
Skin (Cover)



Example of
PMPUSWV1G3S
With Snow Leopard
Skin (Cover)

Compatible load types

	LED
	Incandescent
	Fluorescent
	CFLs
	Electronic transformers
	Standard iron core & toroidal transformers
	Exhaust fans / small motors

Cleaning Guide:

Spraying cleaning products directly on to electrical switches or power points (sockets) is not recommended. It is important to ensure that switches are turned off before cleaning.

Do not use any cleaning sprays - only wipe down with damp cloth or rub with dry cloth. (Do not use an abrasive cloth as it may scratch the plastic). Do not use harsh chemical cleaners as these can break down the plastic and cause it to crack. Do not wash the cover plates in water over 60°C.

Trader Powermesh products must be installed by a qualified electrician. Zimi requires a compatible (Android, iOS) mobile device. All features, functionality and other product specifications are subject to change without notice or obligation. Powermesh products are optimised for the use with the Zimi App. The Bluetooth word mark and logos are registered trademarks owned by the Bluetooth SIG, Inc. The Trader logo is a registered trademark of GSM Electrical (Australia) Pty. Ltd. IOS is a trademark or registered trademark of Cisco Inc. Zimi and Powermesh and their respective logos are registered trademarks of GSM Innovations Pty Ltd. Google Play and the Google Play logo are trademarks of Google Inc. App Store is a service mark of Apple Inc., registered in the U.S. and other countries.

© Copyright 2018 GSM Electrical (Australia) Pty. Ltd. All rights reserved

Powermesh Multi Purpose Switch

- Standard product supplied in classic Puma architecture.
- Covers available in **Trader Leopard, Clouded Leopard & Snow Leopard** (See Data Sheet "PM14")
- Approved to AS/NZ60669.2.1 & AS/NZS CISPR15.
- Fits standard Australian wall boxes and mounting accessories that use 84mm mounting centres.
- Switch terminals have 4mm bore to suit 1.5mm² cable.
- Soft touch control.
- Indicator displays the on/off state.
- Software control using the Zimi app, available on the Google Play and App Store.
- Covers, plates and dollies are made from UV stabilised polycarbonate to avoid discolouring to yellow.
- Standard colour is white. Available in Black. Please check availability.
- Rating 240V AC 50Hz, 10AX
- Neutral connection required (3 wire)
- Multi way switching with multiple devices using 'Behaviour link' (configured using the Zimi app).
- M60 motor rating
- Inbuilt scheduling.
- Power outage recovery.
- Control anywhere in the world via the Internet with the Zimi Cloud Connect (Product Code: PMZCLOUDV1)

Covers available in
Trader Leopard,
Clouded Leopard
& Snow Leopard
styles

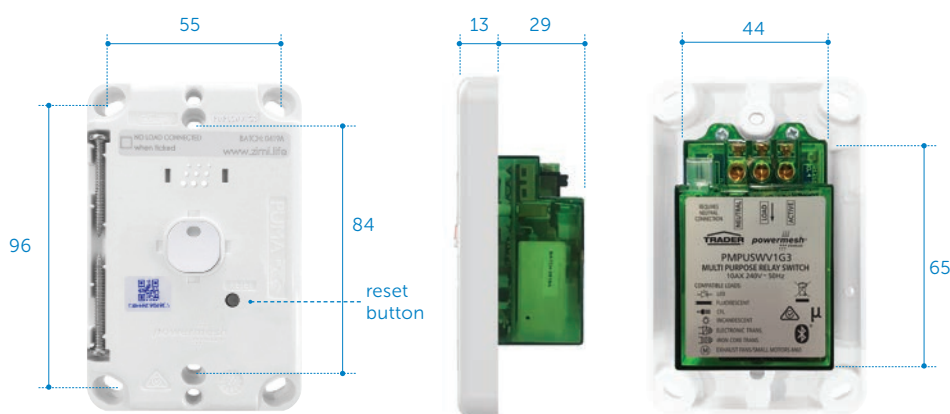

Dimensions in mm

Catalogue Number	Description
PMPUSWV1G3S	Multi Purpose Switch, Vertical 1 Gang 10AX 240V 3 Wire POWERMESH Enabled, White, 3 Skins
PMPUSWV1G3BKS	Multi Purpose Switch, Vertical 1 Gang 10AX 240V 3 Wire POWERMESH Enabled, Black, 3 Skins

Certification Number:
GMA-506939-EA

GSM Electrical (Australia) Pty Ltd
Level 2, 142-144 Fullarton Road, Rose Park SA 5067
P: 1300 301 838 F: 1300 301 778 E: service@gsme.com.au
www.gsme.com.au



Data Specification Sheet
July 2021